

1.) WIRE CLAMP MATERIAL:
GALVANIZED STEEL, WIRE CLAMP
SCREW MATERIAL: ZINC PLATED STEEL

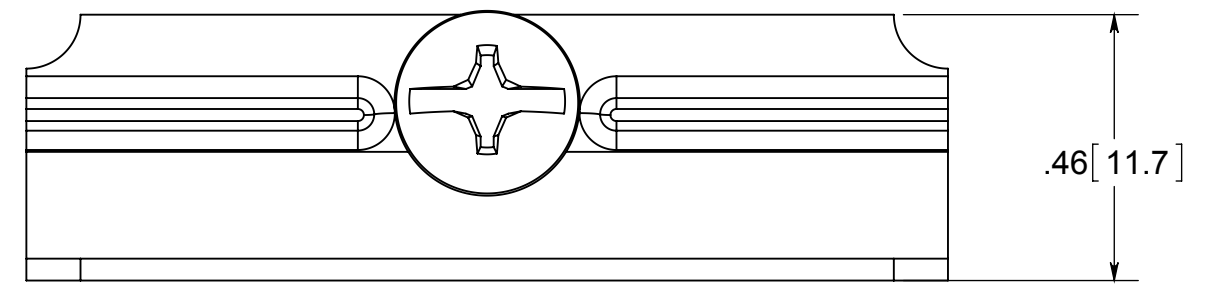

CONFIDENTIAL
THIS MATERIAL IS OWNED BY THE ALLIED MOULDED PRODUCTS COMPANY, IS DISCLOSED IN CONFIDENCE, AND IS NOT TO BE REPRODUCED OR DISTRIBUTED WITHOUT PRIOR WRITTEN PERMISSION FROM ALLIED MOULDED PRODUCTS.

	<p>ALLIED MOULDED PRODUCTS BRYAN, OHIO The Original Fiber Glass Outlet Box</p>
<p>PRODUCT SERIES</p>	
<p>WIRE CLAMP WITH SCREW</p>	
<p>Part No.</p>	<p>WIRE - CLAMP</p>